

DMR Square Steel Keystock

DMR™ Square steel keystock is available in 12" and 36" lengths with the size clearly marked on each bar. The material is 1018 Carbon steel and is available with zinc plating, plain finish, stainless and brass. Standard sizes available from:

1/16"(0.063) - 2-1/2"(2.250).

DMR Rectangular Keystock

DMR™ Rectangular steel keystock is available in 12" and 36" lengths with the size clearly marked on each bar.

The material is 1018 Carbon steel and is available with zinc plating, plain finish, stainless and brass. Standard sizes available from:

1/16" (0.063) - 2-1/2"(2.250).

DMR Metric Keystock

DMR™ Metric Keystock is available in 12" and 1 Meter lengths. Metric Keystock is made of the highest quality zinc plated cold drawn steel. Bars are cut.

The Material is 1018 carbon steel, and is available in zinc plating, plain finish, or stainless steel.

Standard sizes available from 4mm to 25mm.

Rectangular is available as well.

DMR Keystock Kits

Steel - DMR P/N SZC-1

Stainless Steel -DMR P/N SZC-S

Brass -DMR P/N SZC-B

Metric-DMR P/N MK-7-305

861 Cranberry Court
Oakville, ON L6L 6J7

Phone: (905) 847-6500
Fax: (905) 847-6943
email: sales@daemarinc.com

Essential components for industry
www.daemar.com



DMR Step Keystock

DMR™ Step Keystock is available in 12" lengths. DMR step keystock is oversized keystock ground down to A,B-D & C Dimensions. Use for couplings, gears, sheaves, sprockets, pulleys-anything that keys to a shaft. Material is 1018 carbon steel, zinc plating for corrosion resistance.

DMR™ PART #	TYPE	A	B	C	D
SK-1-1	1	3/16"	3/32"	1/8"	1/16"
SK-2-2	2	3/16"	3/32"	1/4"	3/32"
SK-3-2	2	3/16"	3/32"	1/4"	1/8"
SK-4-2	2	1/4"	1/8"	5/16"	1/8"
SK-5-2	2	1/4"	1/8"	3/8"	1/8"
SK-6-2	2	1/4"	1/8"	3/8"	3/16"
SK-7-1	1	3/8"	3/16"	5/16"	1/8"
SK-8-1	1	3/8"	3/16"	5/16"	5/32"
SK-9-2	2	3/8"	3/16"	7/16"	5/32"
SK-10-2	2	3/8"	3/16"	1/2"	3/16"
SK-11-2	2	3/8"	3/16"	1/2"	1/4"
SK-12-1	1	1/2"	1/4"	7/16"	5/32"
SK-13-2	2	1/2"	1/4"	9/16"	3/16"
SK-14-2	2	1/2"	1/4"	5/8"	3/16"

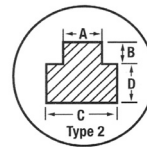
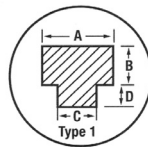
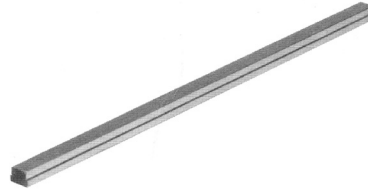

DMR™ PART #	TYPE	A	B	C	D
SK-15-2	2	1/2"	1/4"	5/8"	5/16"
SK-16-2	2	1/2"	1/4"	11/16"	1/4"
SK-17-1	1	5/8"	5/16"	3/8"	3/16"
SK-18-2	2	5/8"	5/16"	11/16"	1/4"
SK-19-1	1	3/4"	3/8"	1/2"	1/4"
SK-20-1	1	3/4"	3/8"	5/8"	3/16"
SK-21-1	1	3/4"	3/8"	5/8"	5/16"
SK-22-1	1	3/4"	3/8"	11/16"	1/4"
SK-23-2	2	3/4"	3/8"	13/16"	9/32"
SK-24-2	2	3/4"	3/8"	7/8"	7/16"
SK-25-2	2	3/4"	3/8"	15/16"	5/16"
SK-26-2	2	3/4"	3/8"	1"	1/2"
SK-27-1	1	1"	1/2"	7/8"	7/16"

DMR Gib Head Key

DMR™ Gib head Key are used for holding pulley and gears tightly on the shaft, They are tapered 1/8" per foot to fit snugly on the shaft and are machined from 1018 steel.



DMR Woodruff Key

DMR™ Woodruff keys are available from stock in 50 S.A.E. standard sizes(1/16" Width up to 2-3/4 Length). Material is machined from 1035 Steel. Woodruff keys are also available in assortment kits.

